

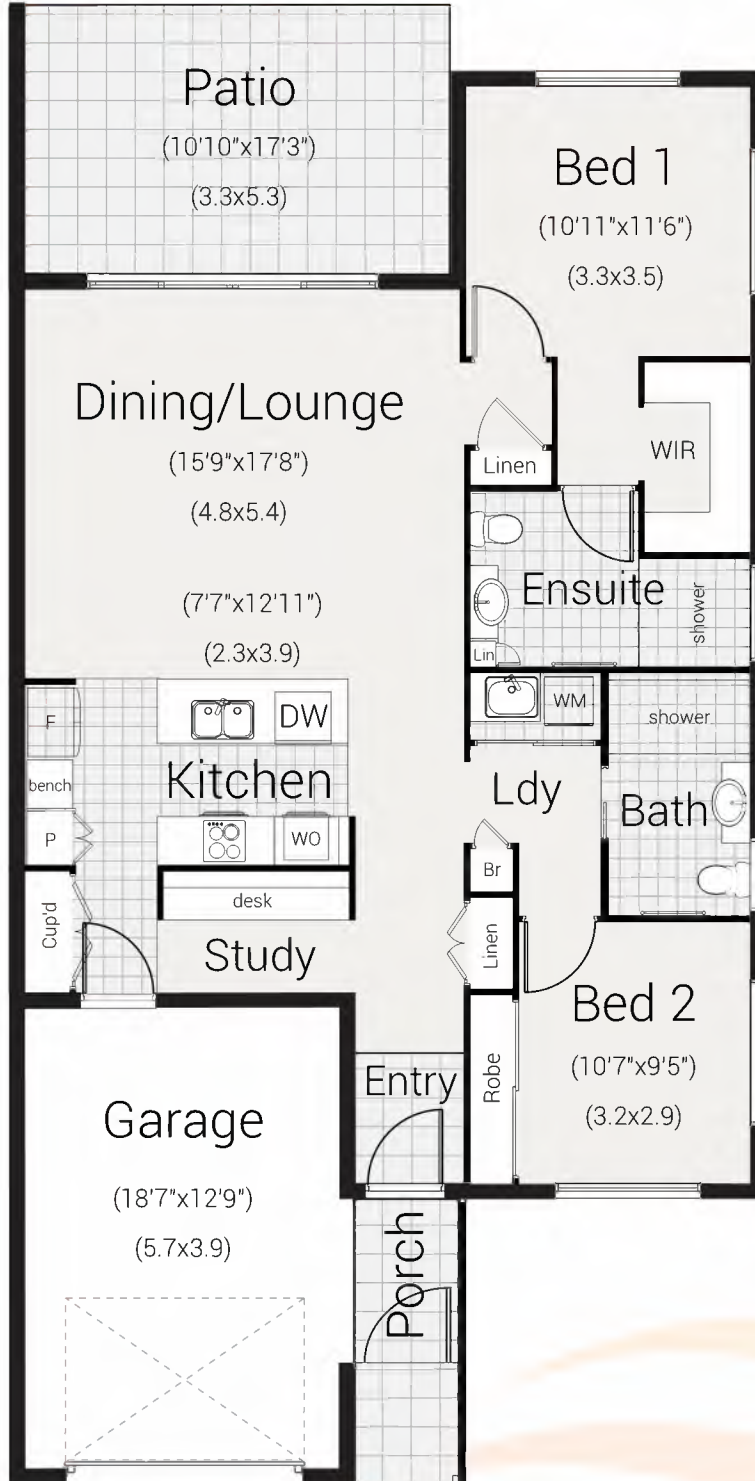

Elm Apartment

ormiston rise
retirement living

2 1 2 2 1



P 07 3821 0971
 E info@ormistonrise.com.au
 W ormistonrise.com.au
 174 Wellington Street
 Ormiston Qld 4160

Living Area	129 sqm	13 sq
Patio Area	18 sqm	2 sq
Porch Area	5 sqm	1 sq
TOTAL AREA	152 SQM	16 SQ

Please Note: Plan is indicative only and subject to change without notice. Table figures are rounded. September 2018