

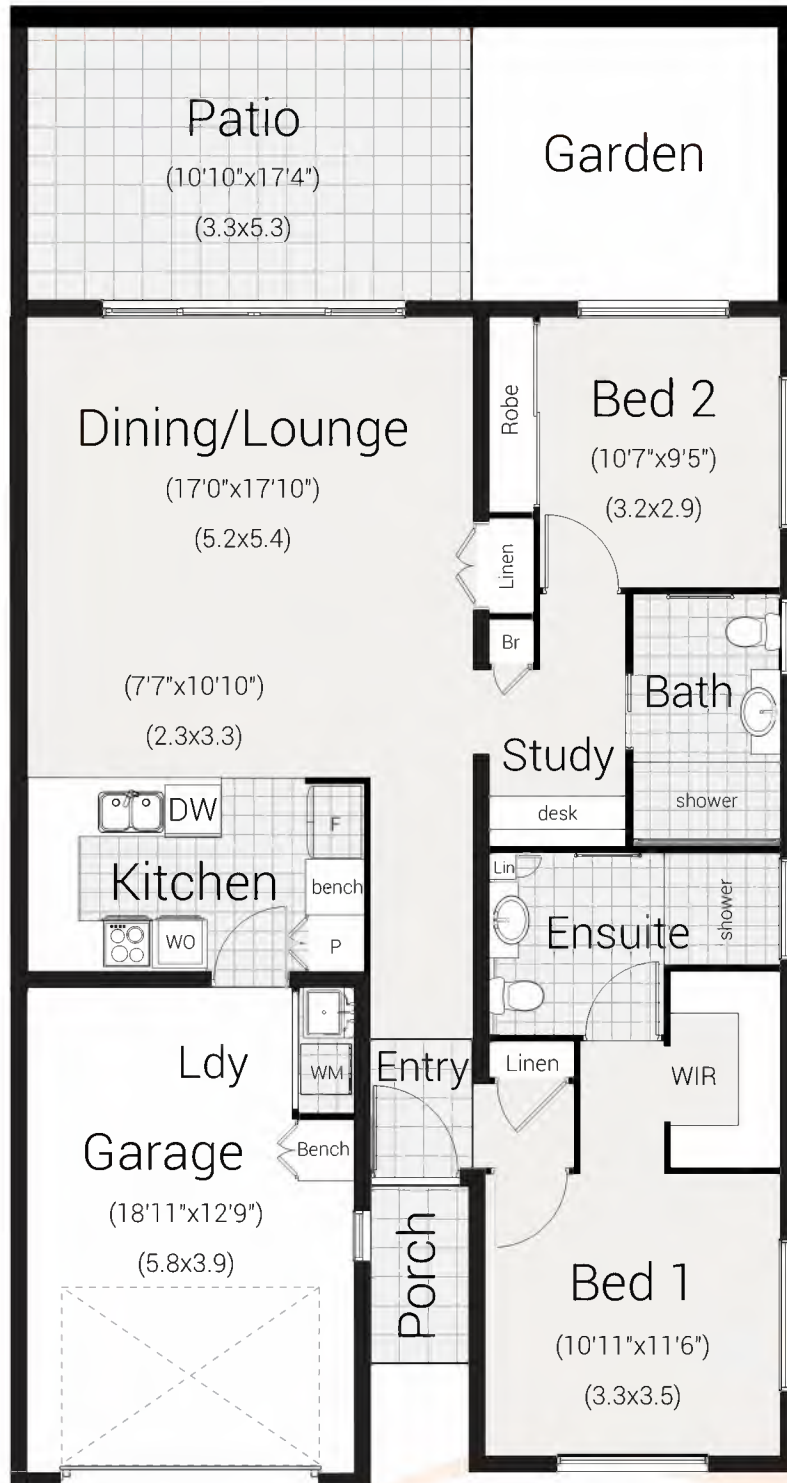

# Elm Garden

ormiston rise  
retirement living

2 1 2 2 1



P 07 3821 0971  
 E [info@ormistonrise.com.au](mailto:info@ormistonrise.com.au)  
 W [ormistonrise.com.au](http://ormistonrise.com.au)  
 174 Wellington Street  
 Ormiston Qld 4160

Living Area	126 sqm	13 sq
Patio Area	18 sqm	2 sq
Porch Area	4 sqm	1 sq
<b>TOTAL AREA</b>	<b>148 SQM</b>	<b>16 SQ</b>

Please Note. Plan is indicative only and subject to change without notice. Table figures are rounded. September 2018